

# SIGHT GAGES - CLOSED CIRCUIT

## G603 SERIES

The G603 Series front mount closed circuit sight gage is mounted securely with end blocks made from aluminum. These end blocks are connected with a clear, flexible tubular vinyl sight providing 360° viewing of the fluid level. The flexible vinyl sight bends easily to conform to irregular or cylindrical shaped reservoir bodies.

### Standard Features:

- Front mount
- 360° of viewing fluid level
- Suitable for use with most hydraulic and machine lubricating oils

### Standard Materials:

- Aluminum end blocks and mounting bolts
- Vinyl tubular sight
- Buna N seals

### Temperature and Pressure Ratings:

- 150°F (65°C) maximum operating temperature
- 5 psi (35 kPa) maximum operating pressure
- Please refer to Temperature Ratings by Seal Material for additional operating conditions (Appendix RA-5 on page RA-A5)

### NOTE:

- Please refer to Appendix RA-11 on page RA-A11 for installation instructions

**CAUTION:** • Not recommended for use with water, steam, acidic fluids, caustic fluids and volatile fluids

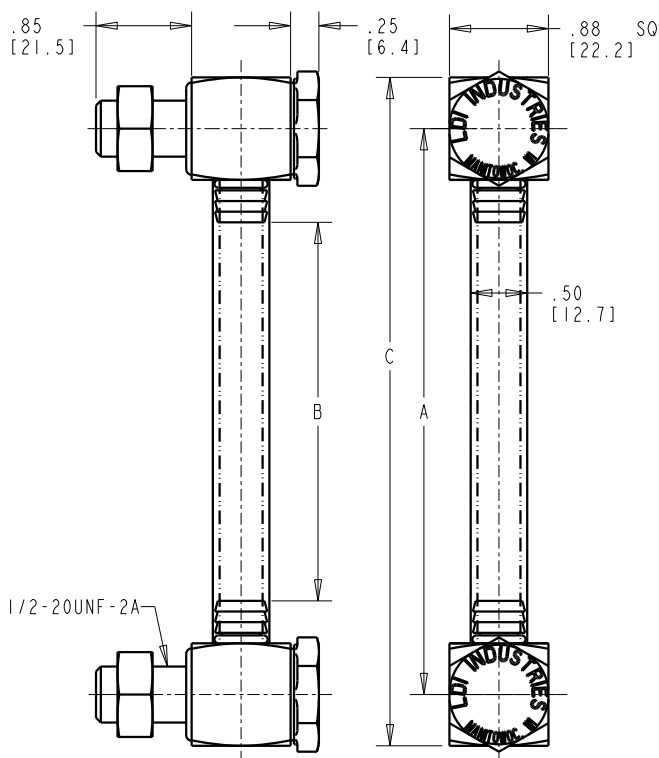

NOTE: All dimensions are inches [mm]

| G603 Series         |                     |                     |
|---------------------|---------------------|---------------------|
| A<br>inches<br>(mm) | B<br>inches<br>(mm) | C<br>inches<br>(mm) |
| 3.00<br>(76.20)     | 1.34<br>(34.04)     | 3.91<br>(9.93)      |
| 4.00<br>(101.60)    | 2.34<br>(59.44)     | 4.91<br>(124.71)    |
| 5.00<br>(127.00)    | 3.34<br>(84.84)     | 5.91<br>(150.11)    |
| 6.00<br>(152.40)    | 4.34<br>(110.24)    | 6.91<br>(175.51)    |
| 7.00<br>(177.80)    | 5.34<br>(135.64)    | 7.91<br>(200.91)    |
| 8.00<br>(203.20)    | 6.34<br>(161.04)    | 8.91<br>(226.31)    |
| 9.00<br>(228.60)    | 7.34<br>(186.44)    | 9.91<br>(251.71)    |
| 10.00<br>(254.00)   | 8.34<br>(211.84)    | 10.91<br>(277.11)   |
| 11.00<br>(279.40)   | 9.34<br>(237.24)    | 11.91<br>(302.51)   |
| 12.00<br>(304.80)   | 10.34<br>(262.64)   | 12.91<br>(327.91)   |

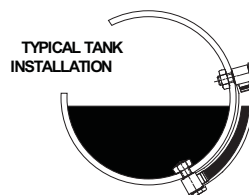

### ORDERING OPTIONS CODES:

#### BODY MATERIAL

- A- Aluminum end blocks (standard)
- B- Brass end blocks (optional)

#### SEAL MATERIAL

- 1- Buna N seals (standard)
- 2- Butyl seals (optional)
- 3- Viton® seals (optional)
- 4- Ethylene propylene seals (optional)

### HOW TO ORDER

#### EXAMPLE:

**G603-05-A-1** — Buna N Seals  
 — Aluminum end blocks  
 — 5.00 (127.00 mm) mounting centers  
 — Series G603

Dimensions and specifications are subject to change without notice. Not all items are Made-To-Stock, contact us for availability.

02/14

Ph : 920-682-6877  
 Fx : 920-684-7210

**LDI Industries**

sales@ldi-industries.com  
 www.ldi-industries.com